

DIMENSIONS OF THE MAIN COMPONENTS

CHAMBER

Effective length	A	46-11/16" (1,183 mm)
Width	B	26" (660 mm)
Height	C	12" (302 mm)
Total length	D	53-1/2" (1,359 mm)
Inlet invert	E	8-1/4" (210 mm)
Channel width	F	5" (126 mm)
Inner width	G	21-1/2" (545 mm)
Weight*		13.5 lb (6.1 kg)
Material		Polypropylene

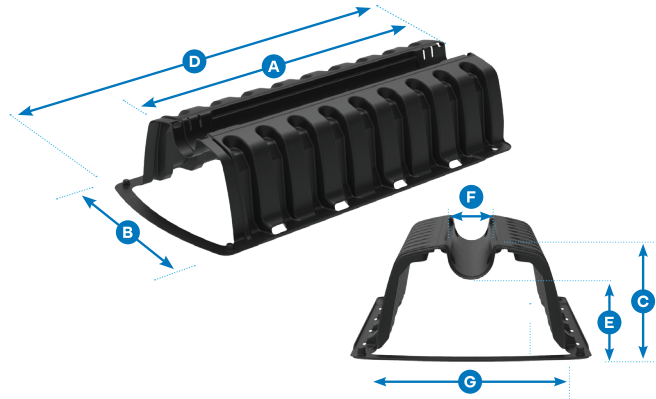

END CAP

Length	A	10-5/8" (270 mm)
Width	B	26-3/8" (670 mm)
Height	C	12" (307 mm)
Inlet invert (starting from sand layer)	D	8-1/4" (210 mm)
Inlet diameter		4-1/2" (114 mm)
Weight*		3 lb (1.4 kg)
Material		Polypropylene

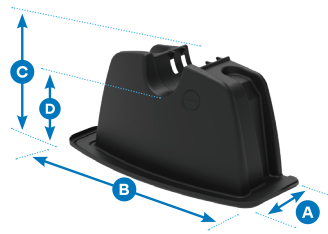

TOP COVER

Effective length	A	46-11/16" (1,183 mm)
Width	B	7-7/8" (200 mm)
Height	C	2-1/4" (28 mm)
Weight*		2.8 lb (1.3 kg)
Material		Polypropylene

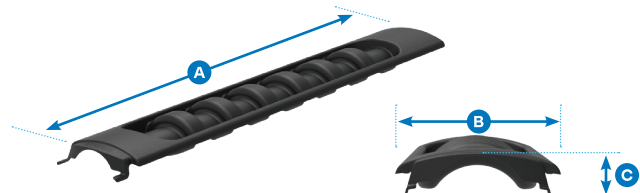

* Weights are for handling and lifting purposes only.
They are approximate and non-binding.



PT Water and Environment

+1 800 632-6356

info.ptwe.na@premiertech.com

PT-WaterEnvironment.com



The information contained in this document was up-to-date and consistent with the information available at the time of publication. Premier Tech Ltd and its affiliated companies make no warranties or representations as to its accuracy. Because of its continuous improvement policy, Premier Tech Ltd and its affiliated companies reserve the right to change and/or discontinue the manufacture of any product and/or modify technical data and prices, for any reason whatsoever and at its sole discretion, without further notice and without liability to anyone in this regard. ECOFLO®, PREMIER TECH® and PREMIER TECH & DESIGN™ are trademarks of Premier Tech Ltd or its affiliates. For current data regarding all patent application(s) and patent(s) for this product or any part thereof, consult the website patentmarking.premiertech.com, with the following references: 1596, 2777, and 8296.

© 2026 Premier Tech Ltd. All rights reserved.